

---

**After Hours...**  
Natural Parterre

Richard Meehan and Kevin Nelson spent an enjoyable day assisting artist Bob Chaplin in the precise layout of his proposed Natural Parterre at the Hillstead Museum in Farmington. The Parterre (French "on the ground") will be a 5120 SF lattice of mowed walkways surrounding untouched interior parcels which will be allowed to grow wild.

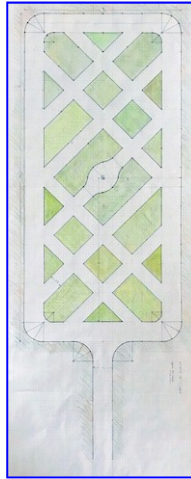

Photos: Bob Chaplin

**Year End Reflections...**

As this year draws to a close, we wish to once again thank you, our clients, for providing us with the opportunity to work with and for you. While the year has had its' challenges, we can safely say that it was better than the year before and now 2019 looks even brighter.

We look forward to new opportunities and new challenges in the year ahead.

See you in 2019!

---

387 North Main Street  
Manchester, CT 06042  
Phone: (860) 643-2520  
Facsimile: (860) 649-8806  
e-mail: info@meehangoodin.com  
Internet: www.meehangoodin.com



---

**Meehan & Goodin**  
Engineers - Surveyors, P.C.  
**Winter 2018 Newsletter**

---



Best wishes  
for you and your loved  
ones from all of us at  
Meehan & Goodin

*Scott Hallatt*  
*Danny*  
*Janice A. Grasser*  
*Kevin Nelson*  
*Ro*  
*Ozzie Touse*  
*Richard Meehan*  
*E. Paul J. Lee*

---

## How Can We Help You Today?

- Site Planning
- Civil Engineering
- Land Surveying
- Permitting

- ◆ Richard Meehan, PLS
- ◆ E. Russell Johnston III, PE
- ◆ Robert E. Dahn, PLS

Call us to see how we can assist you on your next project. (860) 643-2520



## On The Web...

To learn more about our firm, visit us at our Website

[www.meehangoodin.com](http://www.meehangoodin.com)

## Land Use Development Seminars...

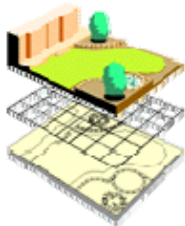

We offer free seminars on land use evaluation, development and planning, as well as on the latest survey standards and codes.

Call Richard Meehan for more information about how to set up a seminar for your group at your location.

## Award of Merit... Capitol Lofts Apartments



The Capitol Lofts apartments project earned an Award of Merit for adaptive use from the Connecticut Trust for Historic Preservation. Meehan & Goodin was part of the award winning project team, providing land surveying and site engineering services. Located at 390 Capitol Avenue, Hartford, the building once contained the Pratt & Whitney Machine Shop among it's former occupants.

## Open for Business... Building Expansion



When Simoniz USA wanted to expand a building at their headquarters in Bolton, they turned to Meehan & Goodin for land surveying, site engineering and land use permitting.

## Project Team Award... Litchfield Courthouse



The Litchfield Judicial District Courthouse project was selected the first-place winner in the 2018 Project Team Awards from the Connecticut Building Congress in the New Construction category and was further selected as the "Project Team of the Year". Meehan & Goodin was part of the award winning project team, providing boundary and topographic surveying services.

## Walk to Work Survey Updates



Continuing a long relationship with the Community Child Guidance Clinic, Meehan & Goodin has prepared an updated boundary and topographic survey in conjunction with a planned expansion. Located only two lots from our office building, this is one project site that our crew could walk to.