

---

## After Hours...

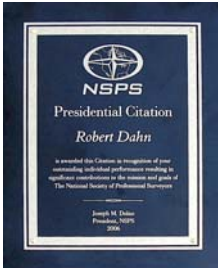

During the 2007 Annual Conference of the National Society of Professional Surveyors in Saint Louis, Robert Dahn was awarded a NSPS Presidential Citation in recognition of his significant contributions to the mission and goals of NSPS. He was also appointed a trustee of the NSPS Foundation and has served on the NSPS Board of Directors since 2004. Bob is a dedicated advocate of the profession of land surveying.

---

## Stormwater Management



Stormwater Management has become a critical component of both the site plan design process and the regulatory approval process. Many of the required Best Management Practices (BMP'S) are outlined in the new "Connecticut Stormwater Quality Manual" by the ConnDEP. In addition to local requirements, any development that disturbs over 5 acres must also file a "Stormwater Pollution Control Plan" and a "General Permit for the Discharge of Stormwater and Dewatering Wastewaters Associated with Construction Activities" to the ConnDEP

In order to keep current on these issues, Russ Johnston and Marc Goodin recently attended a seminar on Storm Sewer System Design and Installation using EPA Recommendations, Structural BMP'S, Water Quality Design, Water Quality Volume, and First Flush Design.

387 North Main Street  
Manchester, CT 06042  
Phone: (860) 643-2520  
Facsimile: (860) 649-8806  
e-mail: info@meehangoodin.com  
Internet: www.meehangoodin.com



**Meehan & Goodin**  
Engineers - Surveyors, P.C.

---

# Meehan & Goodin

## Engineers - Surveyors, P.C.

### Spring 2007 Newsletter

---

### ALTA/ACSM Surveys

When we review the features of our ALTA/ACSM surveys, we typically refer to matters such as utility easements, rights of others to pass across the property and zoning restrictions. Only seldom do you encounter a situation such as the one we recently observed during our survey of the small parcel of land on Ella Grasso Turnpike in Windsor Locks pictured here.



It turns out that the parcel is located directly across the highway from runway #33 at Bradley International Airport and while nothing in the title documents referred to them, the FAA had established aerial height limitations that become lower and lower as they approach the runway. These "aerial contours" are shown as the diagonal lines on our survey shown below.

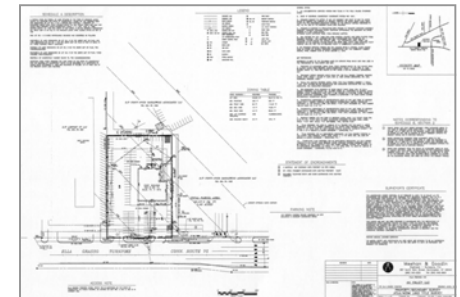

## How Can We Help You Today?

- Site Planning
- Civil Engineering
- Land Surveying
- Permitting

- ◆ Richard Meehan, PLS
- ◆ Marc Goodin, PE
- ◆ E. Russell Johnston III, PE
- ◆ Robert E. Dahn, PLS

Call us to see how we can assist you on your next project. (860) 643-2520

## On The Web...



To learn more about our firm, visit us at our Website  
[www.meehangoodin.com](http://www.meehangoodin.com)

## Land Use Development Seminars...

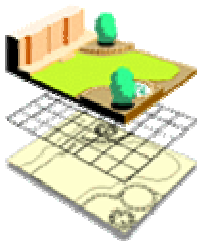

We offer free seminars on land use evaluation, development and planning, as well as on the latest survey standards and codes.

Call Richard Meehan for more information about how to set up a seminar for your group at your location.

## Conceptual Designs... Growing Business



Our parking expansion design in Bristol was barely constructed when a rapidly expanding business found themselves in need of additional workspace. We prepared conceptual designs for a variety of alternative building and parking layouts to assist our Client in meeting their growing needs.

## Approved...

### Two Lot Industrial Subdivision



When the owner of two buildings in Windsor wanted to have the capability of selling one of them to another business, Meehan & Goodin prepared a subdivision plan and application to create separate lots for each building.

## On the Boards... Adaptive Reuse for Surplus Land



Meehan & Goodin assisted this Bristol manufacturer in turning surplus land being under-utilized into a profitable venture by designing rental self-storage buildings in that space. Both the existing and future buildings will be serviced by an expanded shared parking area and a new access layout.

## In the Works... Building Additions



Meehan and Goodin prepared surveys, engineering design and permit applications for three building additions and additional parking spaces for the Concordia Lutheran Church in Manchester.