Historic Longview Farm

(Continued)



1967

Before the first horse takes to pasture, however, there is much work to be done: wetland studies, pasture, hayfield and paddock planning, site re-grading and the construction of two new ponds. We have been working with the Town of Coventry and the U.S. Natural Resource Conservation Service to design the improvements and secure the necessary



Susan Crossen

387 North Main Street
Manchester, CT 06040
Phone: (860) 643-2520
Facsimile: (860) 649-8806
e-mail: info@meehangoodin.com
Internet: www.meehangoodin.com



Meehan & Goodin
Engineers - Surveyors, P.C.

Meehan & Goodin

Engineers - Surveyors, P.C.
Spring 2002 Newsletter



1936

Tradition Continues at the Historic Longview Farm

While active farms continue to rapidly disappear from the Connecticut landscape, Tom and Susan Crossen are bucking the trend. They intend to operate the historically significant Longview Farm in Coventry, Connecticut as a world-class Arabian horse farm and have committed their time and resources to renovating the existing house and outbuildings to their previous splendor.

The property, also know as the Booth-Dimock farm, was the first farmed by the Rev. Chauncey Booth in 1815. It operated as a prosperous dairy farm until the 1970's, a time when small scale farming became less profitable and farmland began to vanish. Were it not for Tom and Susan's hard work and determination, the land and the buildings would likely yield to residential pressures.

How Can We Help You Today?

- Site Planning
- Civil Engineering
- Land Surveying
- Permitting

- ◆ Richard Meehan, LLS
- ◆ Marc Goodin, PE
- ◆ E. Russell Johnston III, PE
- ◆ Robert E. Dahn, LLS
- ◆ Vernon S. Reed, Jr., LLS

Call us to see how we can assist you on your next project. (860) 643-2520

On The Web...



To learn more about our firm, visit us at our Website
www.meehangoodin.com

After Hours...



In keeping with this season's equestrian theme, but otherwise unrelated to our cover feature, Robert Dahn, our Principal Surveyor, recently constructed a horse barn at his Mansfield home. Bob obtained the plans from the North Dakota State University Extension Service and he customized them for his daughter's horse, Serenade.

Mansfield Family Practice



Plans were recently approved by the Town of Mansfield Inland Wetlands Agency and Planning and Zoning Commission for the construction of a 3,250 square foot addition for the Mansfield Family Medical Practice. Development options on the 2.6 acre site were limited by existing features, utility easements and high functioning inland wetlands and required creative and carefully executed designs and safeguards.

Three Presentations - One Night



Russ Johnston recently performed a juggling act of sorts, preparing and presenting three separate projects, for three different clients before the East Hartford Planning and Zoning Commission at their February meeting.

- A new drive-up ATM facility for First New England Federal Credit Union.
- Phase 2 facility expansion for Ecolochem, Inc.
- Relocation of the Board of Education offices for the Town of East Hartford.

Residential and Assisted Living Middletown, Connecticut

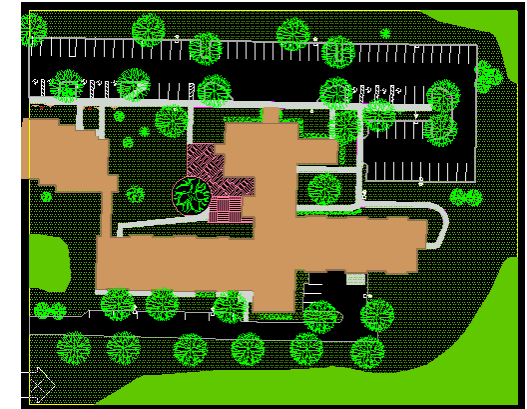

Design plans and applications have been submitted for the renovation and expansion of the Luther Ridge Senior Residential facility in Middletown.

The plans call for the replacement of 45 existing housing units with 90 new housing and assisted living units and the renovation of 6 existing housing units. The completed project will total 95,800 square feet.

The 13.4 acre parcel is characterized by steep slopes, perched upland wetlands and a broad heavily wooded buffer area along the street frontage that the client wished to preserve. A Town mandated zero run-off policy further complicated the design scenario, necessitating particular attention be paid to the storm water design and wetlands preservation.

Client/Owner:

Lutheran Social Services of N.E., Inc.

General Contractor:

Orlando Annulli & Son's, Inc.
Manchester, Connecticut

Architect:

Chia-Ming Sze Architects
Boston, Massachusetts