

After Hours...

National Society of Professional Surveyors (NSPS)

Meehan and Goodin cultivates a company wide commitment to the professions of land surveying and civil engineering. As part of this commitment, Bob Dahn continues his work as a member of the NSPS Board of Directors.

Bob recently represented NSPS at the Canadian Council of Land Surveyors' annual forum in Winnipeg, Manitoba. It is our belief that this kind of dedication enhances our ability to provide the quality services our clients expect and deserve.

Did You Know...

FEMA Flood Map Updates

FEMA is currently implementing a Flood Map Modernization program for the United States. As part of this program, new Flood Maps are now available for Hartford and Middlesex counties.



You can get more information about this program, view the flood maps, and even make your own "FIRMette" like the one shown, by visiting the FEMA website at:

www.fema.gov/plan/prevent/fhm/index.shtm

387 North Main Street
Manchester, CT 06040
Phone: (860) 643-2520
Facsimile: (860) 649-8806
e-mail: info@meehangoodin.com
Internet: www.meehangoodin.com



Meehan & Goodin

Engineers - Surveyors, P.C.

Fall 2008 Newsletter

Renewable Resource

Turn 90° to read the article

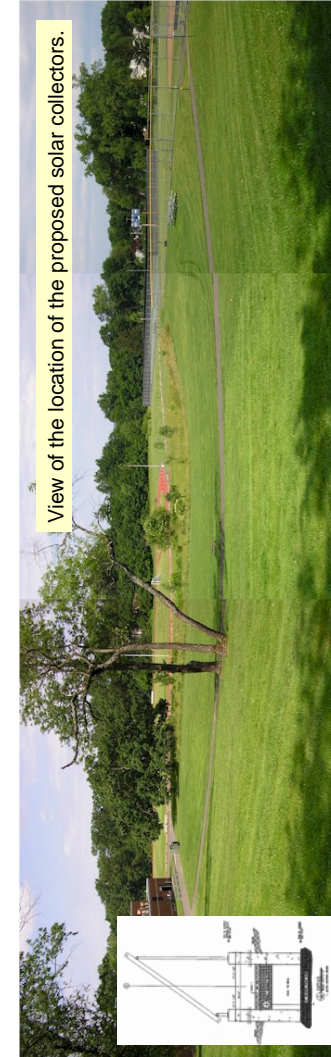

Saint Joseph College recently received land use permits for the installation of ground mounted solar thermal collectors to provide heat for the domestic and indoor pool water of the adjacent O'Connell Athletic Center.

Meehan & Goodin has provided survey and engineering for the College beginning with the original site plan for the O'Connell Athletic Center in 1992 and most recently by providing the surveys and the soil erosion & sediment control plan for this project.

How Can We Help You Today?

- Site Planning
- Civil Engineering
- Land Surveying
- Permitting

- ◆ Richard Meehan, PLS
- ◆ Marc Goodin, PE
- ◆ E. Russell Johnston III, PE
- ◆ Robert E. Dahn, PLS

Call us to see how we can assist you on your next project. (860) 643-2520

On the Boards... Zone Change Application



When an existing house and barn along a busy State road in Bolton came on the market, our client saw an opportunity to relocate their office. Meehan & Goodin prepared a Zone Change application to extend the adjacent "business" zone to this parcel and allow the professional office use.

Approved... Lot Split

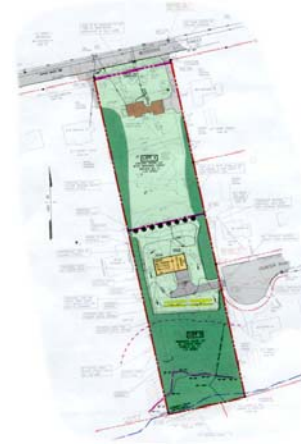

Because the rear portion of this long narrow lot had frontage at the end of a cul-de-sac, we were able to create a new house lot on the south half while maintaining the existing house undisturbed on the north half. Even after the lot split, each of these two lots in Manchester will be more than twice the size of the adjacent parcels to the east.



On The Web...

To learn more about our firm, visit us at our Website

www.meehangoodin.com

On the Boards... Business Expansion



For the second time in the past 4 years, a self storage complex in Manchester has turned to Meehan & Goodin to prepare site plans and applications to meet its expansion needs. Analysis of the anticipated storm drainage indicated that our original 1999 design will have the capacity to handle the runoff from the currently proposed additions as well as our 2004 additions.

In the Works... Parking Enhancements

As part of the renovation and conversion of former mill buildings in Manchester, Meehan & Goodin is preparing the surveys and site plans for related parking improvements and expansion. Shown above is a view through an existing archway between adjacent buildings to the area beyond that will become part of the enhanced parking area.

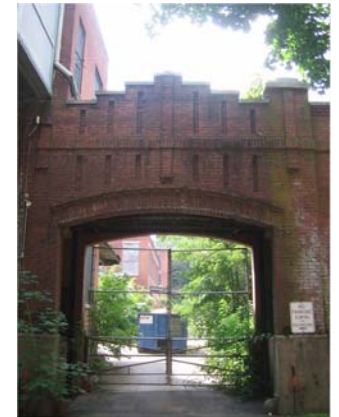

Land Use Development Seminars...

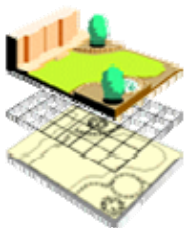

We offer free seminars on land use evaluation, development and planning, as well as on the latest survey standards and codes.

Call Richard Meehan for more information about how to set up a seminar for your group at your location.